

1.floor plan

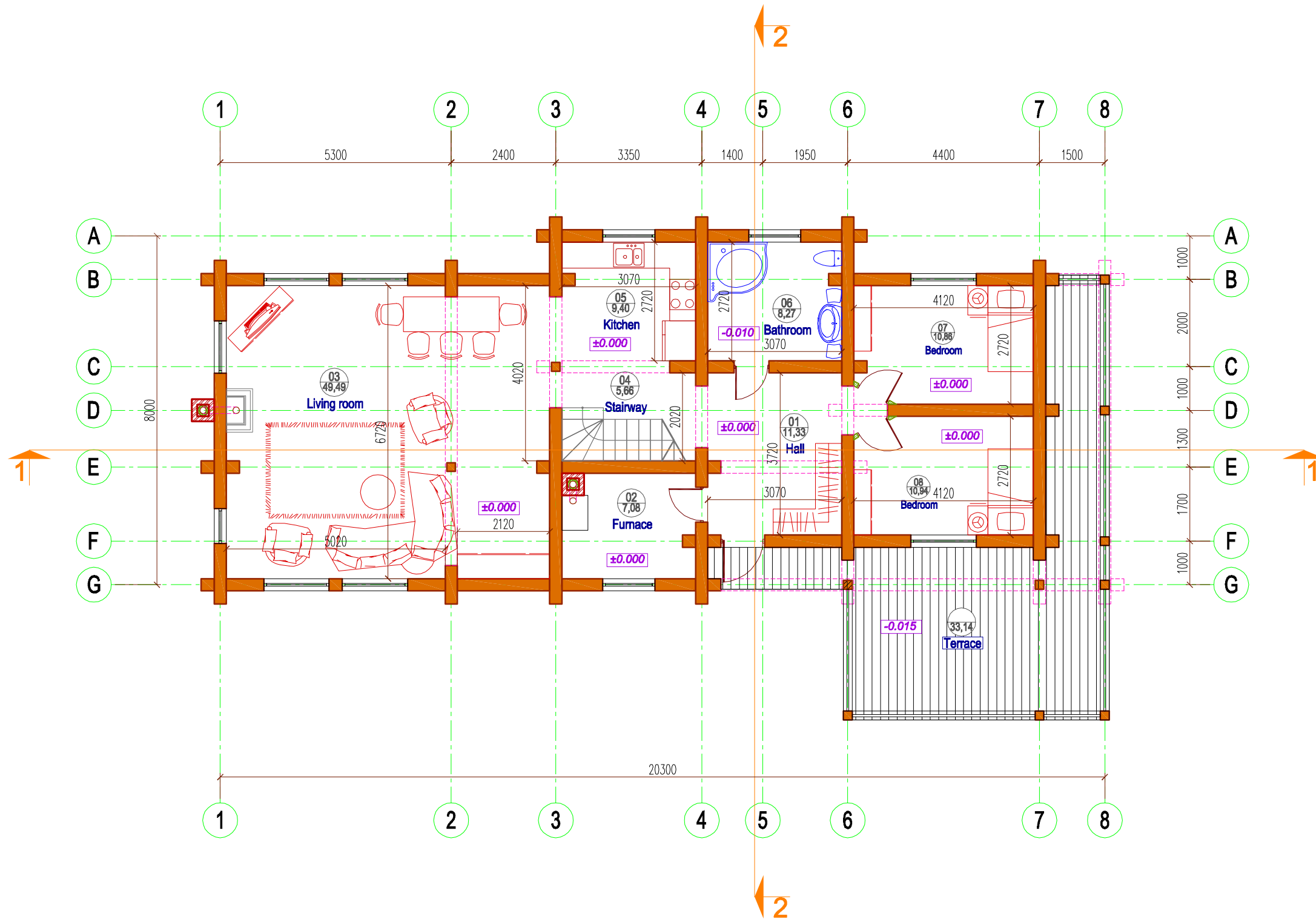

1.floor total area

Room number	Room	Area (m²)
01	Hall	11,33
02	Furnace	7,08
03	Living room	49,49
04	Stairway	5,66
05	Kitchen	9,40
06	Bathroom	8,27
07	Bedroom	10,86
08	Bedroom	10,94
	1.floor total area	113,03
	Terrace	33,14
	Total building area	153,63m²